



Also Selling Autos, Tractors, Equipment & Antiques after real estate, approximately 11:30 AM. Lunch stand available.

AUTOS

1999 Dodge Ram 3500 diesel, 5.9L, one-owner, 13,100 miles, 10' dump bed, VIN #3B6MC3664XM513625; 2012 Chevy Malibu with 39,647 miles, VIN #1G1ZB5E00CF343019; 2004 Chevy Silverado 4x4 w/ 56,511 miles, VIN #1GCEK14T04Z291286.

TRACTORS/CRAWLERS/EQUIPMENT

Farmall Super H w/ loader; Farmall Ht; Farmall 656 gas; Oliver 77 frame & engine; two International TD-6 crawlers; Farmall 460 parts tractor; Farmall H parts tractor; 2 flatbed hay wagons; Woods 3pt. 6' brush hog, needs gearbox; 3pt. 3-bottom plow; old sawmill; old hay/grain elevator; Int. 93 combine w/ corn & grain heads; NH 273 baler; scrap iron piles; Int. U2A power unit; 2-row planter; gravity wagon.

ANTIQUES/TOOLS

Milk cans; oil cans; egg baskets; advt. cans; sander; jig saw; power washer; 5500-watt gas generator; grain cleaner; platform scale; post vises; pulleys; wrenches; TroyBilt riding mower; Husqvarna riding mower; old chairs; dry sink; steel wheels; apple crates; sheet steel pcs.; meat grinder; egg scale; sausage stuffer; wringer washer; meat slicer; ladders; blanket chests; Singer sewing machine; Life magazines; newspapers; oak dinette; old cameras; coolers; file cabinet; piano; etc.

Note

Buildings are full, anything may turn up! Nothing shown until auction day.

Terms On Chattels

Driver's license or State ID required to register for bidder number. Cash, Check, Debit Card, Visa, or MasterCard accepted. 4% buyer's premium on all sales, 4% waived for cash or check when paid sale day. Information is believed to be accurate but not guaranteed. Multi Par auction process may be used.

Auction By Order Of
Charlotte Schweitzer, Trustee



GEORGE P. KIKO
AUCTIONEER/REALTOR®
330.418.1095
george@kikocompany.com



Information is believed to be accurate but not guaranteed.
KIKO Auctioneers



ABSOLUTE AUCTION

SATURDAY, OCTOBER 19, 2024, 10:30 AM
REAL ESTATE SELLS FIRST



REAL ESTATE

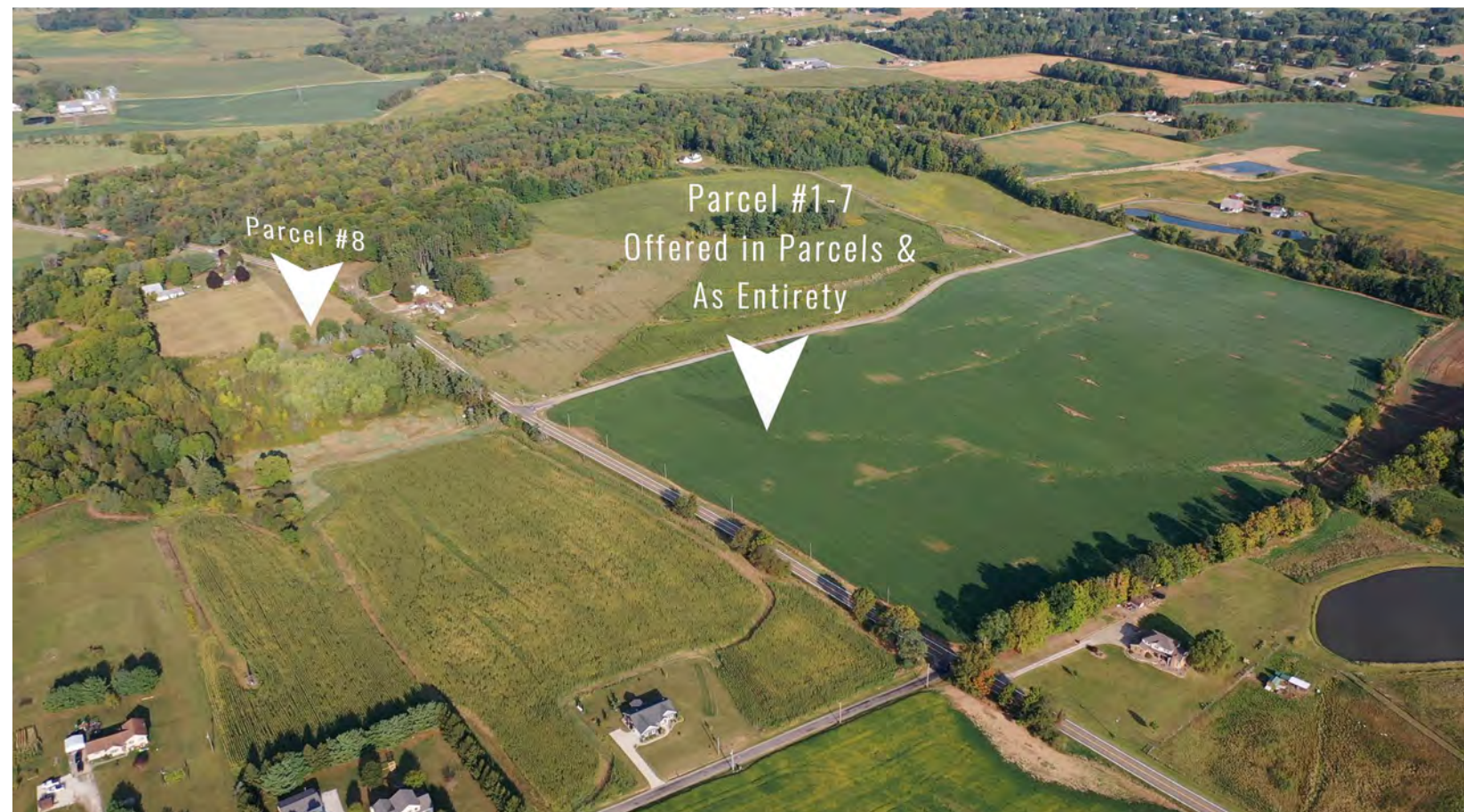

82 ACRES LAND, HOME & BUILDINGS

Osnaburg Twp., Stark Co., OH

10100 LISBON ST. E,
LOUISVILLE, OH 44641

www.kikoauctions.com | 800.533.5456

LIVE AUCTION WITH ONLINE BIDDING

AUCTION HIGHLIGHTS

- 67+ Acres Tillable Land & Future Homesites Offered In 7 Parcels
- 14+ Acres W/ Home & Buildings
- Gently Rolling Land
- Mineral Rights Transfer

ALSO SELLING

- 1999 Dodge Ram 3500 diesel
- 2012 Chevy Malibu
- Farmall Super H W/ Loader
- Two International TD-6 Crawlers



Scan for auction details, including directions.

Absolute Auction.
All sells to the highest bidders on location.



67+ ACRES TILLABLE LAND & FUTURE HOMESITES
Northeast corner of Lisbon St. and Maplegrove Ave.
 Stark Co. parcel #3700849 composed of 67.84 acres of nice gently rolling land w/ good elevation. Nearly all tillable. Current taxes are \$399.94 per half year. Nice parcels ranging from 7+ acre lots up to 14+ acre lots.

Divided as follows:

- Parcel #1:** 10.4-acre corner lot, 470' frontage on Maplegrove & 1,156' frontage on SR 172. Lays nice.
- Parcel #2:** 8-acre rolling land with nice elevation, 300' frontage.
- Parcel #3:** 7.9-acre vacant land, nice elevation, 300' frontage.
- Parcel #4:** 7.8-acre vacant land, lays very nice, 300' frontage.
- Parcel #5:** 9.2-acre vacant land, 300' frontage, lays nice.
- Parcel #6:** 9.4-acre vacant land, 300' frontage, lays nice.
- Parcel #7:** 14.8-acre vacant & wooded land, wildlife on this parcel, 300' frontage.

NOTE

Parcels #1-#7 offered in parcels & as entirety, selling whichever way it brings the most. Parcel #8 will be sold separately. All measurements & references to acreage are approximate and subject to final survey. Look this land over. Perk tests to be performed before auction day. For help with financing or questions, call George Kiko at 330.418.1095.

PARCEL #8: 14+ ACRES W/ HOME & BUILDINGS
10100 Lisbon St., Louisville, OH 44641.

Stark Co. parcel #3702780 features 14.17 acres composed of open tillable land, woods & pasture. All brick bungalow home built in 1955 by the Schweitzer Family features 2 bedrooms & full bath on main level. Eat-in kitchen, living room, rear office room w/ hand sink. One-car upper garage and one-car lower-level garage. Home has full basement with oil FA furnace and central air. Home has updated vinyl windows (2001) and the upper windows in 2022. Enclosed side patio was also completed in 2020. New steel roof in 2017 on entire home. Home has unfinished 2nd level, and 1,745 SF living area. Current half year taxes are \$586. Home due for updates throughout! Outbuildings include 32'x66' bank barn and a 34'x44' block construction bank barn. Also assorted lean-to sheds & outbuildings.

TERMS ON REAL ESTATE

10% down auction day, balance due at closing. A 10% buyer's premium will be added to the highest bid to establish the purchase price. Any desired inspections must be made prior to bidding. All information contained herein was derived from sources believed to be correct. Information is believed to be accurate but not guaranteed.

